

# CSS20RB Clean Steam Separator

CSS20RB-TB  
04/09

# Staitech

## CSS20RB Clean Steam Separator

As steam flows through a system it loses heat energy as a result of radiation. This loss of energy allows tiny droplets of water to form in the steam which are then carried in suspension within the steam flow. Where steam is being used for sterilisation, this entrained moisture will reduce the efficiency of heat transfer between the steam and surface being sterilised, potentially compromising validation. Entrained moisture also has a damaging effect on control valves and other pipeline components leading to increased maintenance and reduced equipment service life.

The CSS20RB separator uses a series of internal baffles to remove entrained moisture from the steam flow, offering a simple and efficient means to conditioning steam over a wide range of pressure and flow conditions.

Manufactured in 316L stainless steel, the CSS20RB is designed to allow the internal baffle plate to be removed. Available in sizes 1/2" - 3", the CSS20RB can be supplied with a range of surface finish options. A vent connection option is available for all sizes.

### Features offered by the CSS20RB include:

- 316L stainless steel construction - maximum corrosion resistance in clean steam service.
- Self-draining design - eliminates possibility of condensate retention.
- Removeable baffle plate design - allows all internal surfaces to be offered with a specified surface finish.

### Product specification

Sizes*	1/2", 3/4", 1", 1-1/2", 2", 2-1/2" & 3"
Connections	ASME BPE clamp
Drain connection:	1/2" - 1" CSS20RB - 3/4" ASME BPE clamp All other sizes - 1" ASME BPE clamp
Optional vent connection:	1/2" - 1" CSS20RB - 3/4" ASME BPE clamp All other sizes - 1" ASME BPE clamp
Maximum operating conditions	8 barg@175°C
Surface finish:	Wetted surfaces finished to 0.5 microns Ra with internal welds as-laid or ground flush and polished. External surfaces a satin polish finish or as required
Electropolishing:	All wetted surfaces can be electropolished if required. Citric acid passivation is carried out as part of the electropolishing process. Passivation of non polished units is also available upon request.

\*4" available upon request.

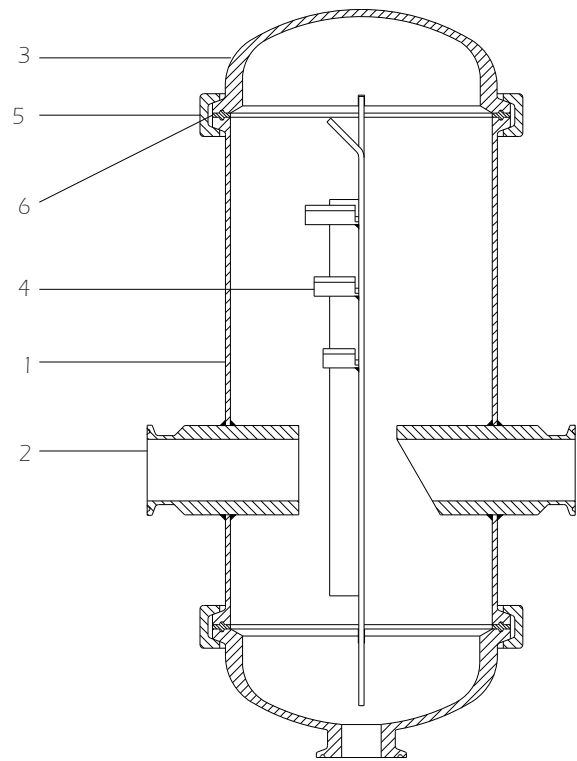

### Materials of construction

1.	Body	316L Stainless steel
2.	Side fittings	316L Stainless steel
3.	End caps	316L stainless steel
4.	Baffle plate	316L Stainless steel
5.	Clamps*	316 stainless steel
6.	Seals**	PTFE-Viton

\*2-piece high pressure bolted design(SSH)

\*\*FDA and USP Class VI compliant

### Design criteria

The CSS20RB range are designed and manufactured in compliance with the European Pressure Equipment Directive and where relevant, ASME BPE 2005 guidelines.

### Certification

Full certification is available to cover construction materials and surface finish.

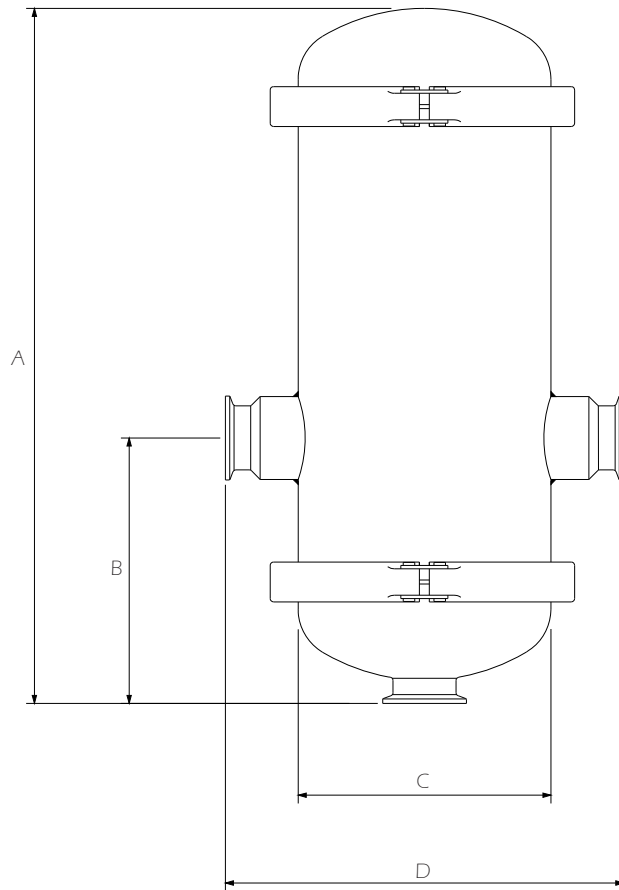

**Dimensions(mm)**

	A	B	C	D
1/2"	296	126	102	147
3/4"	296	126	102	147
1"	296	126	102	147
1-1/2"	420	160	152	240
2"	525	200	152	240
2-1/2"	565	220	152	240
3"	650	250	152	240

*Add 15mm to 'A' dimension when vent specified*

**Separator capacities** - typically, a line sized unit will be suitable based on a maximum steam velocity of 25 m/s. For further sizing details consult Staitech.